



OFFICE 903-693-0377
FAX 903-693-4708
110 S. SYCAMORE RM 212
CARTHAGE, TEXAS 75633

County of Panola

**JUSTICE OF THE PEACE
TONI HUGHES
PRECINCT TWO**

June 21, 2021

Honorable County Judge LeeAnn Jones
Commissioner Billy Alexander
Commissioner David Cole
Commissioner Craig Lawless
Commissioner Dale LaGrone

Re: Approval of Temporary Clerk

Dear Judge and Sirs:

Please record the employment of Mary Sue Kiper as Temporary Clerk with the Panola County Justice of the Peace, Precinct 2/3 Office. Effective June 28, 2021 and ending on December 28, 2021, at a rate of \$15.00 per hour.

If you have any questions, please feel free to contact my office at 903-693-0377.

Respectfully,

Toni Hughes
Justice of the Peace
Panola County Precinct Two

cc: Joni Reed, County Treasurer
Jennifer Stacy, County Auditor



June 28, 2021

FROM: Melanie Earle, Road and Bridge Warehouse Coordinator

TO: Joni Reed, County Treasurer

SUBJECT: EFFECTIVE DATE OF SEPARATION OF EMPLOYMENT:

Please be advised of the effective date of separation of employment for Micheal Cureton, Operator, for Panola County Road & Bridge Department, Pct. 1, effective June 24, 2021 at 5:00 p.m.

Melanie Earle

Melanie Earle

Road and Bridge

Warehouse Coordinator



Panola County Sheriff's Office

Sheriff Sarah Fields

Office 903-693-0333
Fax 903-693-9366

314 W Wellington
Carthage, Texas 75633

July 1, 2021

The Honorable LeeAnn Jones
Panola County Judge
110 S. Sycamore
Carthage, Texas 75633

Dear Judge Jones,

Please add the following item(s) to the next scheduled meeting of the Panola County Commissioner's Court:

Please record termination of Kassi Orbaugh as a Detention Officer for the Panola County Sheriff's Office effective July 1, 2021.

Sincerely,

Sarah Fields
Sheriff

KL/lw

CC: Jennifer Stacy
Joni Reed

Donation

Date June 28, 2021

The undersigned has secured a contribution from Rockcliff Energy to Panola County for use in the Panola County Road and Bridge Fund. This contribution consists of:

\$ 1,169,650.82 and/or

material of the following type and amount Soil Cement & Green Rock

This donation is to be used as needed by the Panola County Road and Bridge Department CR #463 North & South End; CR #466 & CR #467 to improve Panola County road number _____, or if no road is indicated, then it is to be used to improve any Panola County road as seen fit by the Department. This donation must be accepted by the Panola County Commissioners' Court according to Local Govt. Code sec. 81.032 and Transportation Code sec. 252.214 and any money will be held by the Panola County Treasurer pending approval of deposit in the Road and Bridge Fund. Any material will not be used prior to the approval of the Court.

I acknowledge that this is intended as a donation and that no person or corporation has been promised any other benefit because of the donation, nor have been induced or coerced in any way by any official or employee of Panola County. I further certify that this donation was given freely and voluntarily.

[Signature] Commissioner, Precinct# 4

Sworn and subscribed to this 28th day of June, 2021.

[Signature], Notary Public, State of Texas, My commission expires 1-6-2023

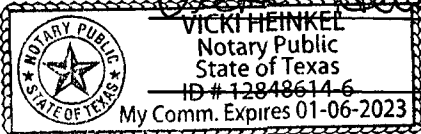

(Panola County Commissioners' Court use only)

This item was accepted / ~~disapproved~~ (strike one) at a meeting of the Panola County Commissioners' Court on this 6th day of July, 2021.
County Judge [Signature]

NOTICE OF PROPOSED INSTALLATION
PIPELINE AND/OR UTILITY LINES

TO: THE PANOLA COUNTY COMMISSIONER'S COURT

c/o

PANOLA COUNTY ROAD & BRIDGE DEPARTMENT, CARTHAGE, TEXAS
Formal notice is hereby given that:

TANOS Exploration proposes to place a
(COMPANY NAME)

10-12" Water line within the Right-of-Way
(PIPE SIZE)

of County Road: 155 + 15B (North & South) as follows:
(NUMBER OF ROAD)

The proposed pipeline will cross under the indicated roads on the attached sheet.
Installation shall be made by boring a total length of _____ line in Panola County.

(NO BORE)
The location and description of the proposed line and appurtenances is more fully shown
by the copies of the drawings attached to this notice. The line will be constructed and
maintained on the County Right-of-Way as directed by the County Commissioners in
accordance with current Panola County Specifications.

Construction of this line will begin on or after the 10th day of
July, 2021.

FIRM: TANOS Exploration
BY: Randy Permatin
TITLE: Operations Landman
ADDRESS: P. 21 E SE Loop 323, Suite 400
Tyler, TX 75701
PHONE: (1) 903-594-8367

APPROVAL

July 6, 2021

TO: TanosExploration
Attn: Randy Permenter
821 ESE Loop 323, Suite 400
Tyler, Texas 75701

RE: **CR #155 & #158 (North & South)**

The Panola County Commissioners' Court offers no objection to the location on the right-of-ways of your proposed **10 - 12" water line** within the right-of-way of County Roads **#155 & #158 (North & South)** as shown by accompanying drawings and notice except as noted below.

It is expressly understood that the County Commissioners' Court does not purpose hereby, to grant any right, claim, title or easement in or upon this county road. It is further understood that in the future should for any reason the county need to work, improve, relocate, widen, increase, add to, or in any manner change the structure of this right-of-way, any required relocation of said lines shall be at the sole expense of owner.

All work on the county right-of-way shall be performed in accordance with the county instructions. The installations shall not damage any part of the road and adequate provisions must be made to cause minimum inconvenience to traffic and adjacent owners. Special specifications for placing this line are as follows:

1. All lines are to be installed a minimum of 36 inches below the flow line of the adjacent drainage or barrow ditch.
2. All excavation within the right-of-way and not under surfacing shall be backfilled by tamping in 6 inch horizontal layers. All surplus material shall be removed from the right-of-way and the excavation finished flush with surrounding natural ground.
3. Lines crossing under surfaced roads and under surfacing cross roads within the right-of-way shall be placed by boring. Boring shall extend from crown line to crown line. Gravity from sewer lines under roadways shall be cast iron pipe.
4. All lines, where practicable, shall be located to cross roadbed at approximately right angles thereto. No lines are to be installed under or within 50 feet of either end of any bridge. No lines shall be placed in any culvert or within 10 feet of the closest point of same.

5. Parallel line will be installed as near the right-of-way lines as is possible and no parallel line will be installed in the roadbed or between the drainage ditch and the roadbed without special permission of the Panola County Commissioners' Court.
6. Operations along roadbeds shall be performed in such manner that all excavated material be kept off the pavement at all times, as well as all operating equipment and materials. No equipment or installation procedures will be used which will damage any road surface or structures. The cost of any repairs to road surface, roadbed, structures or other right-of-way features as a direct result of this installation will be borne by the owner of this line.
7. Barricades, warning signs, lights, and flag man(men) when necessary shall be provided by the contractor or owner. One-half (1/2) of the traveled portion of the road must be open at all times.

Approved: 
COUNTY JUDGE

COMMISSIONERS:

Precinct #1 Billy Alexander
Precinct #2 David A. Cole
Precinct #3 Craig M. Lawless
Precinct #4 Dale LaGrone

152

TANOS EXPLORATION

Panola County, Texas

VERA DAVIS / CHADWICK #1H

MAURITZEN / BRANNON #1H

WATER TRANSFER ROUTE

500'

- Crossings: 10 in. (including one behind in. span pad)
- Culvert Crossings: under roads

Jones Family
22 Acres

State Highways
Crossing
Jones Family
Property
Approximate

Vera Davis / Chadwick #1H
Brannon / Mauritzen #1H

Frac Date: July 18, 2021

Rate: 65 BPM

Stages: 59 Stages (2 wells)

Route Length: +/- 3.0 Miles

Bids Due: Noon June 22, 2021

161

160

315

155

153

**NOTICE OF PROPOSED INSTALLATION
PIPELINE AND/OR UTILITY LINES**

TO: THE PANOLA COUNTY COMMISSIONER'S COURT

c/o

PANOLA COUNTY ROAD & BRIDGE DEPARTMENT, CARTHAGE, TEXAS

Formal notice is hereby given that:

Pilot Water Solutions SWD LLC

proposes to place a

(COMPANY NAME)

Six inch (6")

line within the Right-of-Way

(PIPE SIZE)

of County Road: 463 as follows:
(NUMBER OF ROAD)

The proposed pipeline will cross under the indicated roads on the attached sheet. Installation shall be made by boring a total length of 100' line in Panola County.

The location and description of the proposed line and appurtenances is more fully shown by the copies of the drawings attached to this notice. The line will be constructed and maintained on the County Right-of-Way as directed by the County Commissioners in accordance with current Panola County Specifications.

Construction of this line will begin on or after the 19th day of July, 2021.

FIRM: Pilot Water Solutions SWD LLC

BY: David P. Orgeron

TITLE: Contract Landman

ADDRESS: 14625 S Cougar Rd

Abbeville, LA 70510

PHONE: (337) 852-4275

APPROVAL

July 6, 2021

TO: Pilot Water Solutions SWD, LLC
Attn: David P. Orgeron
14625 S. Cougar Rd.
Abbeville, LA 70510

RE: **CR #463**

The Panola County Commissioners' Court offers no objection to the location on the right-of-ways of your proposed **6" line** within the right-of-way of County Roads **#463** as shown by accompanying drawings and notice except as noted below.

It is expressly understood that the County Commissioners' Court does not purpose hereby, to grant any right, claim, title or easement in or upon this county road. It is further understood that in the future should for any reason the county need to work, improve, relocate, widen, increase, add to, or in any manner change the structure of this right-of-way, any required relocation of said lines shall be at the sole expense of owner.

All work on the county right-of-way shall be performed in accordance with the county instructions. The installations shall not damage any part of the road and adequate provisions must be made to cause minimum inconvenience to traffic and adjacent owners. Special specifications for placing this line are as follows:

1. All lines are to be installed a minimum of 36 inches below the flow line of the adjacent drainage or barrow ditch.
2. All excavation within the right-of-way and not under surfacing shall be backfilled by tamping in 6 inch horizontal layers. All surplus material shall be removed from the right-of-way and the excavation finished flush with surrounding natural ground.
3. Lines crossing under surfaced roads and under surfacing cross roads within the right-of-way shall be placed by boring. Boring shall extend from crown line to crown line. Gravity from sewer lines under roadways shall be cast iron pipe.
4. All lines, where practicable, shall be located to cross roadbed at approximately right angles thereto. No lines are to be installed under or within 50 feet of either end of any bridge. No lines shall be placed in any culvert or within 10 feet of the closest point of same.

5. Parallel line will be installed as near the right-of-way lines as is possible and no parallel line will be installed in the roadbed or between the drainage ditch and the roadbed without special permission of the Panola County Commissioners' Court.
6. Operations along roadbeds shall be performed in such manner that all excavated material be kept off the pavement at all times, as well as all operating equipment and materials. No equipment or installation procedures will be used which will damage any road surface or structures. The cost of any repairs to road surface, roadbed, structures or other right-of-way features as a direct result of this installation will be borne by the owner of this line.
7. Barricades, warning signs, lights, and flag man(men) when necessary shall be provided by the contractor or owner. One-half (1/2) of the traveled portion of the road must be open at all times.

Approved: 
COUNTY JUDGE

COMMISSIONERS:

Precinct #1 Billy Alexander
Precinct #2 David A. Cole
Precinct #3 Craig M. Lawless
Precinct #4 Dale LaGrone

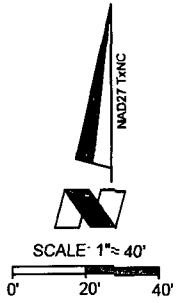

- LEGEND:**
- PROPOSED PIPELINE
 - x- FENCE LINE
 - - - EXISTING PIPELINE
 - TANK BERM
 - - - UGE UNDERGROUND ELECTRIC LINE
 - ⊕ CENTERLINE
 - DRPCT DEED RECORDS PANOLA COUNTY, TEXAS

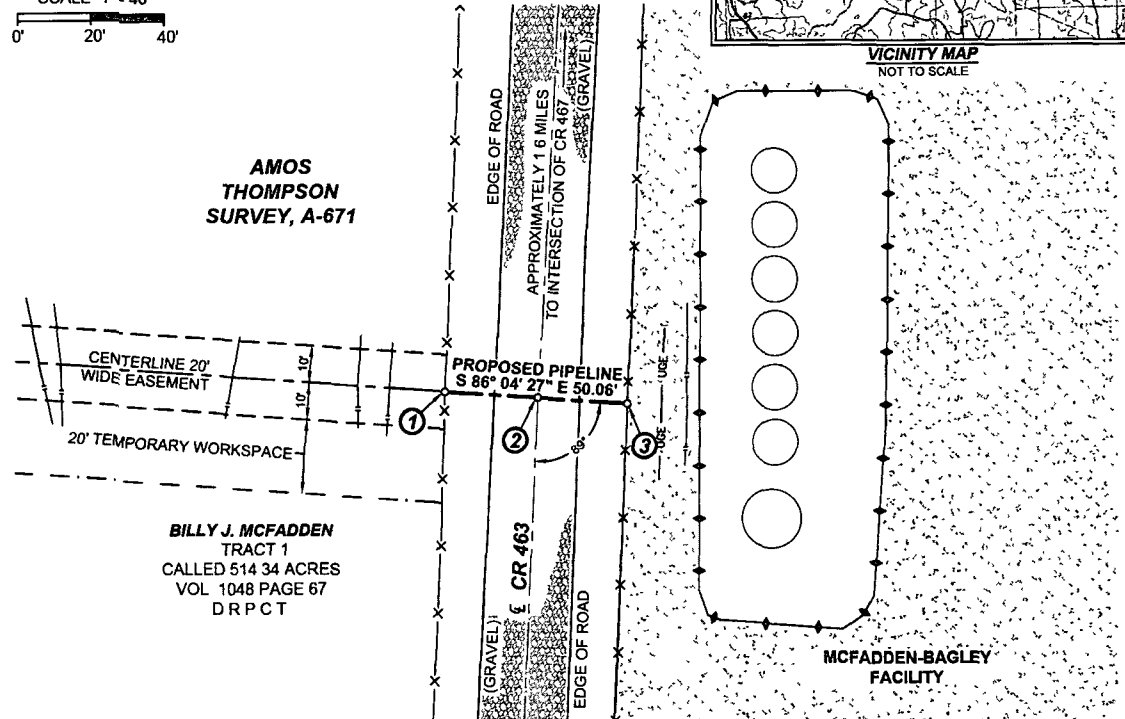
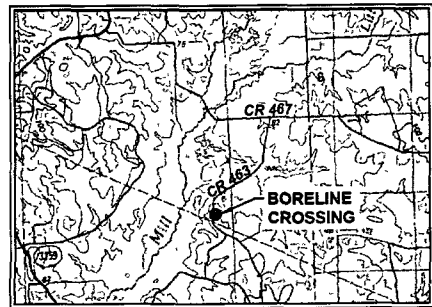

① **PIPELINE MARKER WESTERLY FENCE LINE INTERSECTION.**
 X = 3,063,532.91' (NAD27 TXNC)
 Y = 182,308.73'
 LAT 32° 07' 12.45" N (NAD83/2011)
 LONG 94° 03' 52.61" W
 ELEV 270.5' (NAVD88)

② **CR 463 INTERSECTION.**
 X = 3,063,568.38' (NAD27 TXNC)
 Y = 182,304.98'
 LAT 32° 07' 12.43" N (NAD83/2011)
 LONG 94° 03' 52.32" W
 ELEV 269.3' (NAVD88)

③ **PIPELINE MARKER EASTERLY FENCE LINE INTERSECTION.**
 X = 3,063,582.85' (NAD27 TXNC)
 Y = 182,303.31'
 LAT 32° 07' 12.40" N (NAD83/2011)
 LONG 94° 03' 52.03" W
 ELEV 268.4' (NAVD88)

- NOTES:**
- This plat represents a survey made on the ground for a road crossing permit and is intended solely for that purpose. Lease Lines and Deed Lines shown hereon were established from field measurements and record data. This plat does not meet the requirements for boundary surveys in the State of Texas and shall not be used to convey title to real property.
 - All bearings, distances, areas, and coordinates refer to the Texas Coordinate System of 1927, North Central Zone US Survey Feet. Elevations refer to the North American Vertical Datum of 1988 and are derived from static and kinematic GPS observations unless noted otherwise.
 - Texas maintains information centers that establish links between those who dig (excavators) and those who own and operate underground facilities (operators). It is advisable for the contractor to contact the center for assistance in locating and marking underground utilities. For guidance, contact Texas811 (www.texas811.org).

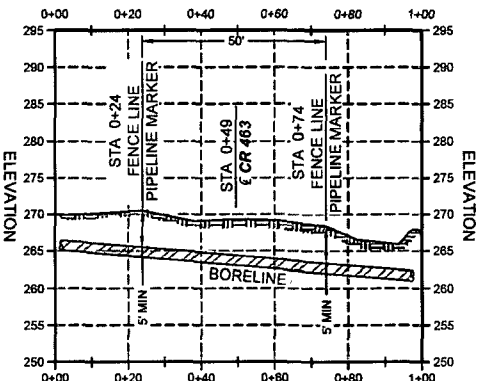

PROFILE VIEW
 HORIZONTAL SCALE 1" = 40'
 VERTICAL SCALE 1" = 20'

FENSTERMAKER & Associates, LLC
 5005 Riverway Drive
 Suite 300
 Houston, TX 77056
 713-840-9995
 TX Firm 100285-01

REVISIONS	

DRAWN BY SAB	PROJ MGR LJG
DATE 04/30/2021	
JOB# 2213203.00C	SHEET 1 OF 1
FILENAME PL_XING_CR_463.DWG	

FOR THE EXCLUSIVE USE OF
 PILOT WATER SOLUTIONS
 I, Leroy J. Gary Jr., Registered Professional
 Land Surveyor, do hereby state the above plat to
 be true and correct to the best of my knowledge
PRELIMINARY
 THIS DOCUMENT SHALL NOT BE RECORDED FOR ANY
 PURPOSE AND SHALL NOT BE USED OR VIEWED OR
 RELIED UPON AS A FINAL SURVEY DOCUMENT

Leroy J. Gary Jr.
 Registered Professional Land Surveyor
 Registration No. 6264

PILOT WATER SOLUTIONS
SABINE ROYALTY #5 SWD #2
FLOWLINE
PROPOSED PIPELINE
BORELINE CROSSING OF
COUNTY ROAD 463
 SITUATED IN THE
AMOS THOMPSON SURVEY, A-671
PANOLA COUNTY, TEXAS

**PANOLA COUNTY
2021
BUDGET AMENDMENT #14**

We hereby amend the Panola County Budget for the Fiscal Year 2021 as set forth above according to the procedures outlined under Local Government Code, Chapter 111, Subchapter A Sections 111.010 (c), (d). A copy of this Order is to be filed with the County Clerk and Attached to the Budget originally adopted for 2021.

Signed on this 6th day of July, 2021.

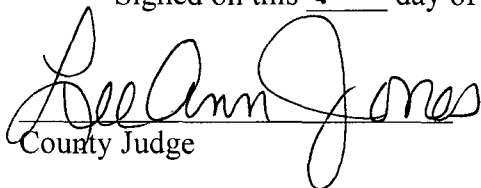
County Judge

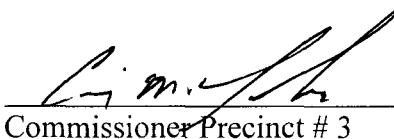

Commissioner Precinct # 1

Commissioner Precinct # 3

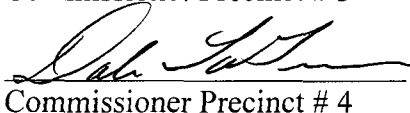
Commissioner Precinct # 2

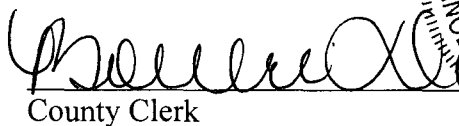

Commissioner Precinct # 4

Passed and approved by the Commissioners Court of Panola County on the 6th day of July, 2021, as the same appears on file in the office of the County Clerk of Panola County.

County Clerk

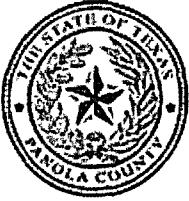

July 6, 2021



Panola County, Texas

Budget Adjustment Register

Adjustment Detail

Packet: GLPKT16475 - 2021-7-6 #14

Adjustment Number	Budget Code	Description	Adjustment Date
BA0001374	2021 COUNTY BUDGET JAN	409-BENEFITS TERMINATION PAY	7/6/2021

Summary Description:

Account Number	Account Name	Adjustment Description	Before	Adjustment	After
<u>100-409-54080</u>	CONTINGENCY	409-BENEFITS TERMINATION PAY	176,319.00	-10,000 00	166,319 00
July	-10,000 00				
<u>100-560-51800</u>	BENEFITS TERMINATION PAY	409-BENEFITS TERMINATION PAY	15,000 00	10,000.00	25,000 00
July.	10,000 00				

Budget Adjustment Register

Packet: GLPKT16475 - 2021-7-6 #14

Budget Code Summary

Budget	Budget Description	Account	Account Description	Before	Adjustment	After
2021	2021 COUNTY BUDGET JA	<u>100-409-54080</u>	CONTINGENCY	176,319.00	-10,000.00	166,319.00
		<u>100-560-51800</u>	BENEFITS TERMINATION PAY	15,000.00	10,000.00	25,000.00
			2021 Total:	191,319.00	0.00	191,319.00
			Grand Total:	191,319.00	0.00	191,319.00

Fund Summary

Fund	Before	Adjustment	After
<i>Budget Code.2021 - 2021 COUNTY BUDGET JAN-DEC Fiscal: 2021</i>			
100	191,319.00	0.00	191,319.00
Budget Code 2021 Total:	191,319.00	0.00	191,319.00
Grand Total:	191,319.00	0.00	191,319.00

Emergency Management Institute



FEMIA

This Certificate of Achievement is to acknowledge that
THOMAS L EARLE
has reaffirmed a dedication to serve in times of crisis through continued professional development and completion of the independent study course:

IS-00100.c
Introduction to Incident Command System, ICS-100

A handwritten signature in black ink, appearing to read "J. Stern", written over a horizontal line.

Issued this 21st Day of June, 2021



Jeffrey D. Stern, Ph.D.
Superintendent
Emergency Management Institute
Federal Emergency Management Agency

Form #2201 Rev. 09/2017

Submit to:
SECRETARY OF STATE
Government Filings
Section P O Box 12887
Austin, TX 78711-2887
512-463-6334
512-463-5569 - Fax
Filing Fee: None



STATEMENT OF OFFICER

FILED FOR RECORD
IN MY OFFICE
AT 9:20 O'CLOCK A M

AUG 06 2021

BOBBIE DAVIS
COUNTY CLERK, PANOLA COUNTY, TEXAS

BY B. Davis DEPUTY

Statement

I, Mary Sue Kiper, do solemnly swear (or affirm) that I have not directly or indirectly paid, offered, promised to pay, contributed, or promised to contribute any money or thing of value, or promised any public office or employment for the giving or withholding of a vote at the election at which I was elected or as a reward to secure my appointment or confirmation, whichever the case may be, so help me God.

Title of Position to Which Elected/Appointed: Temporary Justice of the Peace, Precincts #2 & #3 Clerk

Execution

Under penalties of perjury, I declare that I have read the foregoing statement and that the facts stated therein are true.

Date: June 28, 2021

Mary Sue Kiper
Signature of Officer

Form #2204 Rev 9/2017
Submit to:
SECRETARY OF STATE
Government Filings Section
P O Box 12887
Austin, TX 78711-2887
512-463-6334
FAX 512-463-5569
Filing Fee: None



OATH OF OFFICE

This space reserved for office use
FILED FOR RECORD
IN MY OFFICE

AT 9:20 O'CLOCK A M

AUG 06 2021

BOBBIE DAVIS
COUNTY CLERK, PANOLA COUNTY, TEXAS
BY B. Davis DEPUTY

IN THE NAME AND BY THE AUTHORITY OF THE STATE OF TEXAS,
I, Mary Sue Kiper, do solemnly swear (or affirm), that I will faithfully
execute the duties of the office of Temporary Justice of the Peace, Precincts #2 & #3 Clerk of
the State of Texas, and will to the best of my ability preserve, protect, and defend the Constitution and laws
of the United States and of this State, so help me God.

Mary Sue Kiper
Signature of Officer

Certification of Person Authorized to Administer Oath

State of Texas
County of Panola

Sworn to and subscribed before me on this 28th day of June, 2021.

(Affix Notary Seal,
only if oath
administered by a
notary)

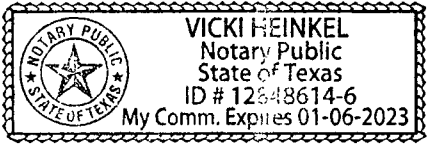

Vicki Heinkel
Signature of Notary Public or
Signature of Other Person Authorized to Administer An
Oath

Vicki Heinkel
Printed or Typed Name



Panola County, Texas

Fund Balance Report

As Of 06/30/2021

Fund	Beginning Balance	Total Revenues	Total Expenses	Ending Balance
100 - GENERAL	17,914,658.33	17,554,953.60	7,773,144.37	27,696,467.56
130 - LAW LIBRARY	87,251.40	7,364.70	5,867.70	88,748.40
140 - COUNTY JUVENILE DELINQUENCY PREVENTION FUND	169.50	0.44	0.00	169.94
150 - COURTHOUSE SECURITY	239,122.23	6,310.35	8,036.48	237,396.10
160 - RECORDS MANAGEMENT	27,650.01	2,282.78	2,205.18	27,727.61
162 - COUNTY & DISTRICT COURT T	6,775.01	235.06	0.00	7,010.07
165 - COURT RECORD PRESERVATION	12,447.41	1,406.27	0.00	13,853.68
166 - DISTRICT COURT RECORDS TECHNOLOGY	20,012.53	1,532.22	0.00	21,544.75
168 - DISTRICT CLERK RECORDS MANAGEMENT & PRESERVATION	7,835.75	809.31	32.50	8,612.56
170 - COUNTY CLERK RECORDS PRES	583,234.57	42,448.75	6,500.00	619,183.32
175 - ARCHIVE FEES	283,596.34	36,999.58	0.00	320,595.92
180 - JUSTICE COURT TECHNOLOGY	101,649.05	1,012.40	9,841.12	92,820.33
190 - V I T INTEREST	2,117.18	5.11	412.39	1,709.90
195 - ELECTION SERVICES CONTRAC	22,939.62	283.06	0.00	23,222.68
200 - ROAD & BRIDGE	7,127,996.51	5,710,022.47	2,517,864.17	10,320,154.81
252 - PANOLA COUNTY AUCTION PROCEEDS	52.93	0.13	0.00	53.06
300 - FM & LATERAL	2,228,646.17	586,896.04	406,568.32	2,408,973.89
410 - SUPERVISION	82,624.07	262,990.39	265,540.43	80,074.03
420 - COMMUNITY CORRECTIONS SUPERVISION SERVICES	0.94	47,520.00	35,704.42	11,816.52
481 - PANOLA COUNTY CSCD ADULT DRUG COURT	26,934.46	1,304.46	0.00	28,238.92
520 - PANOLA JUVENILE PROBATION	47,170.94	1,825.47	0.00	48,996.41
530 - JUVENILE TITLE IV-E	135,974.35	744.86	0.00	136,719.21
540 - TIPC/ C C P FUND	5,048.75	45,777.00	46,223.81	4,601.94
552 - REGIONAL DIVERSION ALTERNATIVES PROGRAM	2,423.00	1,277.20	2,423.00	1,277.20
555 - PRE & POST ADJUDICATION	2,733.00	57,431.00	21,068.00	39,096.00
560 - TIPC/A/18(REGULAR)	9,974.24	39,703.00	44,104.60	5,572.64
580 - COMMITMENT REDUCTION PROG	0.00	5,833.00	0.00	5,833.00
582 - MENTAL HEALTH SERVICES GRANT N	9,000.00	5,947.00	9,000.00	5,947.00
585 - LOCAL MATCH FUNDING/ CALE	299,469.58	199,234.00	164,250.69	334,452.89
700 - HOT CHECK FEE	38,937.31	495.00	464.88	38,967.43
720 - PRETRIAL INTERVENTION PROGRAM FUND	9,593.83	1,929.86	0.00	11,523.69
800 - SHERIFF'S STATE FORFEITUR	70,307.29	163.41	10,900.92	59,569.78
810 - JAIL COMMISSARY FUND	26,583.71	1,748.43	0.00	28,332.14
812 - CORONAVIRUS RELIEF FUND	98,091.44	0.00	0.00	98,091.44
820 - DA FORFEITURE	39,750.11	112.20	0.00	39,862.31
830 - STATE APPORTIONMENT - DA	832.32	18,348.46	11,100.26	8,080.52
835 - STATE LONGEVITY PAY SUPPL	325.65	0.88	0.00	326.53
840 - CONST PCT 2 STATE FORFEIT	1,052.96	1.84	0.00	1,054.80
842 - CONST PCT 1 STATE FORFEIT	196.80	0.35	0.00	197.15
860 - SHERIFF FEDERAL FORFEITUR	6,346.37	11.07	0.00	6,357.44
866 - CONSTABLE PCT 2&3 FEDERAL	59,523.92	163.26	0.00	59,687.18
881 - CHILD PROTECTIVE SERVICES	321.90	0.56	0.00	322.46
883 - HEALTH FUND	169,129.84	31,876.57	20,374.00	180,632.41
885 - AIRPORT	3,804,659.14	58,195.44	14,780.28	3,848,074.30
920 - ROAD BOND 1971	459,963.55	23,627.34	25,032.47	458,558.42
940 - PERMANENT IMPROVEMENT	298,024.49	737.78	0.00	298,762.27
950 - JAIL IMPROVEMENT FUND	234,185.10	568.45	0.00	234,753.55
968 - PANOLA COUNTY RETIREE HEA	467.39	1.29	0.00	468.68
974 - CHILD SUPPORT PAYMENTS/EXPERTPAY	34,405,152.50	996,056.81	762,783.20	34,638,406.11
	0.04	0.00	0.00	0.04
Report Total	69,010,947.53	25,756,168.65	12,164,223.19	82,602,892.99



Panola County, Texas

Treasurers Report Summary

Date Range: 06/01/2021 - 06/30/2021

Fund	Beginning Cash Balance	Revenues	Expenses	Net Change Assets	Net Change Liabilities	Calculated Ending Balance	Actual Ending Balance	Calculated - Actual Ending
100 - GENERAL	918,014 07	874,618 35	1,208,476 99	0 00	11,545 96	572,609 47	572,609 47	0 00
110 - CREDIT CARD CLEARING FUND	9,569 24	0 00	0 00	0 00	9,207 24	362 00	362 00	0 00
112 - JP CREDIT CARD CLEARING	15,185 64	0 00	0 00	0 00	14,530 64	655 00	655 00	0 00
130 - LAW LIBRARY	34,222 50	525 90	0 00	0 00	0 00	34,748 40	34,748 40	0 00
140 - COUNTY JUVENILE DELINQUENCY PREVENTION FUND	163 94	0 00	0 00	0 00	0 00	163 94	163 94	0 00
150 - COURTHOUSE SECURITY	49,951 29	496 48	51 67	0 00	0 00	50,396 10	50,396 10	0 00
160 - RECORDS MANAGEMENT	21,483 06	250 92	6 37	0 00	0 00	21,727 61	21,727 61	0 00
162 - COUNTY & DISTRICT COURT T	6,973 23	36 84	0 00	0 00	0 00	7,010 07	7,010 07	0 00
165 - COURT RECORD PRESERVATION	13,763 68	90 00	0 00	0 00	0 00	13,853 68	13,853 68	0 00
166 - DISTRICT COURT RECORDS TECHNOLOGY	21,444 14	100 61	0 00	0 00	0 00	21,544 75	21,544 75	0 00
168 - DISTRICT CLERK RECORDS MANAGEMENT & PRESERVATION	8,591 26	53 80	32 50	0 00	0 00	8,612 56	8,612 56	0 00
170 - COUNTY CLERK RECORDS PRES	214,894 62	2,588 70	0 00	0 00	1,300 00	216,183 32	216,183 32	0 00
175 - ARCHIVE FEES	265,556 03	2,039 89	0 00	0 00	0 00	267,595 92	267,595 92	0 00
180 - JUSTICE COURT TECHNOLOGY	28,740 43	79 90	0 00	0 00	0 00	28,820 33	28,820 33	0 00
190 - V.I.T. INTEREST	1,709 90	0 00	0 00	0 00	0 00	1,709 90	1,709 90	0 00
195 - ELECTION SERVICES CONTRAC	23,222 68	0 00	0 00	0 00	0 00	23,222 68	23,222 68	0 00
200 - ROAD & BRIDGE	833,775 40	276,072 23	455,669 72	0 00	6,023 10	648,154 81	648,154 81	0 00
252 - PANOLA COUNTY AUCTION PROCEEDS	53 06	0 00	0 00	0 00	0 00	53 06	53 06	0 00
300 - FM & LATERAL	214,032 54	30,889 44	34,623 54	0 00	1,324 55	208,973 89	208,973 89	0 00
410 - SUPERVISION	77,558 04	25,942 00	23,365 70	0 00	60 31	80,074 03	80,074 03	0 00
420 - COMMUNITY CORRECTIONS SUPERVISION SERVICES	3,370 88	11,880 00	3,434 36	0 00	0 00	11,816 52	11,816 52	0 00
481 - PANOLA COUNTY CSCD ADULT DRUG COURT	28,073 10	165 82	0 00	0 00	0 00	28,238 92	28,238 92	0 00
520 - PANOLA COUNTY JUVENILE PROBATION	38,812 32	179 50	0 00	0 00	0 00	38,991 82	38,991 82	0 00
530 - JUVENILE TITLE IV-E	66,584 18	139 62	0 00	0 00	0 00	66,723 80	66,723 80	0 00
540 - TIPC/ C C A P FUND	8,505 52	0 00	3,903 58	0 00	0 00	4,601 94	4,601 94	0 00
552 - REGIONAL DIVERSION ALTERNATIVES PROGRAM	1,277 20	0 00	0 00	0 00	0 00	1,277 20	1,277 20	0 00
553 - REGIONAL REIMBURSEMENT PROGRAM	0 00	0 00	0 00	0 00	0 00	0 00	0 00	0 00
555 - PRE & POST ADJUDICATION	39,396 00	0 00	300 00	0 00	0 00	39,096 00	39,096 00	0 00
560 - TIPC/A/183(REGULAR)	8,184 13	0 00	2,611 49	0 00	0 00	5,572 64	5,572 64	0 00
572 - PROBATION PAYROLL FUND	354 82	0 00	0 00	0 00	-7,966 45	8,321 27	8,321 27	0 00
580 - COMMITMENT REDUCTION PROG	5,833 00	0 00	0 00	0 00	0 00	5,833 00	5,833 00	0 00
582 - MENTAL HEALTH SERVICES GRANT N	5,947 00	0 00	0 00	0 00	0 00	5,947 00	5,947 00	0 00
585 - LOCAL MATCH FUNDING/ CALE	268,157 93	0 00	13,705 04	0 00	0 00	254,452 89	254,452 89	0 00
700 - HOT CHECK FEE	17,922 43	45 00	0 00	0 00	0 00	17,967 43	17,967 43	0 00
720 - PRETRIAL INTERVENTION PROGRAM FUND	11,523 69	0 00	0 00	0 00	0 00	11,523 69	11,523 69	0 00
800 - SHERIFFS STATE FORFEITUR	36,557 81	11 97	0 00	0 00	0 00	36,569 78	36,569 78	0 00
810 - JAIL COMMISSARY FUND	28,332 14	0 00	0 00	0 00	0 00	28,332 14	28,332 14	0 00

Jim W. Head
7-1-2021

Treasurers Report

Date Range: 06/01/2021 - 06/30/2021

Fund	Beginning Cash Balance	Revenues	Expenses	Net Change Assets	Net Change Liabilities	Calculated Ending Balance	Actual Ending Balance	Calculated - Actual Ending
812 - CORONAVIRUS RELIEF FUND	97,690 70	0 00	0 00	0 00	0 00	97,690 70	97,690 70	0 00
820 - D A FORFEITURE	35,854 33	7 98	0 00	0 00	0 00	35,862 31	35,862 31	0 00
830 - STATE APPORTIONMENT - DA	8,080 52	0 00	0 00	0 00	0 00	8,080 52	8,080 52	0 00
835 - STATE LONGEVITY PAY SUPPL	326 53	0 00	0 00	0 00	0 00	326 53	326 53	0 00
840 - CONST PCT 2 STATE FORFEIT	1,054 80	0 00	0 00	0 00	0 00	1,054 80	1,054 80	0 00
842 - CONST PCT 1 STATE FORFEIT	197 15	0 00	0 00	0 00	0 00	197 15	197 15	0 00
860 - SHERIFF FEDERAL FORFEITUR	6,357 44	0 00	0 00	0 00	0 00	6,357 44	6,357 44	0 00
862 - CDA FEDERAL FORFEITURE	59,687 18	0 00	0 00	0 00	0 00	59,687 18	59,687 18	0 00
866 - CONSTABLE PCT 2&3 FEDERAL	322 46	0 00	0 00	0 00	0 00	322 46	322 46	0 00
881 - CHILD PROTECTIVE SERVICES	50,974 53	30,041 88	1,384 00	0 00	0 00	79,632 41	79,632 41	0 00
883 - HEALTH FUND	404,935 43	2,393 42	2,254 55	0 00	0 00	405,074 30	405,074 30	0 00
885 - AIRPORT	328,959 56	1,598 86	0 00	0 00	0 00	330,558 42	330,558 42	0 00
920 - ROAD BOND 1971	60,602 71	159 56	0 00	0 00	0 00	60,762 27	60,762 27	0 00
940 - PERMANENT IMPROVEMENT	42,633 88	119 67	0 00	0 00	0 00	42,753 55	42,753 55	0 00
950 - JAIL IMPROVEMENT FUND	468 68	0 00	0 00	0 00	0 00	468 68	468 68	0 00
968 - PANOLA COUNTY RETIREE HEA	467,727 57	106,583 64	129,000 10	0 00	6,905 00	438,406 11	438,406 11	0 00
972 - PAYROLL FUND	23,183 61	0 00	0 00	0 00	-147,239 24	170,422 85	170,422 85	0 00
974 - CHILD SUPPORT PAYMENTS/EXPERTPAY	0 04	0 00	0 00	0 00	-519 16	519 20	519 20	0 00
980 - CRIMINAL JUSTICE	40,012 45	0 00	0 00	0 00	-6,945 87	46,958 32	46,958 32	0 00
981 - CRIMINAL JUSTICE CIVIL	7,221 73	0 00	0 00	0 00	-1,603 43	8,825 16	8,825 16	0 00
982 - APPELLATE JUDICIAL FEES	4,375 60	0 00	0 00	0 00	-752 06	5,127 66	5,127 66	0 00
Report Total:	4,968,403.80	1,367,111.98	1,878,819.61	0.00	-114,129.41	4,570,825.58	4,570,825.58	0.00

Opri W. Reed
7-1-2021

**PANOLA COUNTY INVESTMENT REPORT
MARCH 31, 2021**

<i>INVESTMENTS AS OF DECEMBER 31, 2020</i>	76,294,686 04		
	Investments	Maturity	Int Rate
Beginning Balance 01-01-2021	76,294,686 04		
<i>Matured 01/07/2021 (Purchased on 10/08/2020)</i>	(17,738,000 00)		
<i>Matured 01/07/2021 (Purchased on 10/08/2020)</i>	(10,700,000 00)		
Purchase of CD No. 21304402796 on 01/07/2021	15,138,000 00	4/8/2021	0 800%
General Fund	10,000,000 00		
Law Library	20,000 00		
Courthouse Security	58,000 00		
Records Management	1,000 00		
CC Records Preservation	118,000 00		
Archive	17,000 00		
Justice Court Technology	20,000 00		
Road & Bridge	3,150,000 00		
FM & Lateral Road	500,000 00		
Hot Check Fee	6,000 00		
Sheriff's State Forfeiture	7,000 00		
Child Protective Services	20,000 00		
Health Fund	1,043,000 00		
Airport	38,000 00		
Road Bond 1971	78,000 00		
Permanent Improvement	62,000 00		
Purchase of CD No. 21304402797 on 01/07/2021	10,700,000 00	4/8/2021	0 800%
Retiree Health Benefit Trust	10,700,000 00		
<i>Matured 02/18/2021 (Purchased on 11/12/2020)</i>	(5,297,614 21)		
Purchase of CD No. 21304402811 on 02/18/2021	7,138,000 00	5/20/2021	0 800%
General Fund	5,138,000 00		
Road & Bridge	1,900,000 00		
FM & Lateral Road	100,000 00		
<i>Matured 03/11/2021 (Purchased on 12/03/2020)</i>	(5,702,071 83)		
<i>Matured 03/11/2021 (Purchased on 12/03/2020)</i>	(9,815,000 00)		
<i>Matured 03/11/2021 (Purchased on 12/03/2020)</i>	(11,648,000 00)		
<i>Matured 03/11/2021 (Purchased on 12/10/2020)</i>	(3,814,000 00)		
<i>Matured 03/11/2021 (Purchased on 12/10/2020)</i>	(11,400,000 00)		
<i>Matured 03/11/2021 (Purchased on 12/10/2020)</i>	(180,000 00)		
Purchase of CD No. 21304402812 on 03/11/2021	11,620,000 00	6/10/2021	0 800%
General Fund	6,284,000 00		
Law Library	18,000 00		
Courthouse Security	70,000 00		
Records Management	2,000 00		
CC Records Preservation	105,000 00		
Archive	20,000 00		
Justice Court Technology	23,000 00		
Road & Bridge	2,672,000 00		
FM & Lateral Road	1,000,000 00		
Hot Check Fee	5,000 00		
Sheriff's State Forfeiture	6,000 00		
DA State Forfeiture	4,000 00		
Child Protective Services	21,000 00		
Health Fund	1,200,000 00		
Airport	50,000 00		
Road Bond 1971	80,000 00		
Permanent Improvement	60,000 00		
Purchase of CD No. 21304402813 on 03/11/2021	11,500,000 00	6/10/2021	0 800%
Retiree Health Benefit Trust	11,500,000 00		
Purchase of CD No. 21304402814 on 03/11/2021	160,000 00	6/10/2021	0 800%
Panola Juvenile Probation	10,000 00		
Title IV-E	70,000 00		
Local Match Juvenile Probation	80,000 00		
Purchase of CD No. 21304402815 on 3/11/2021	9,815,000 00	9/9/2021	0 800%
General Fund	6,000,000 00		
Law Library	16,000 00		
Courthouse Security	59,000 00		
Records Management	3,000 00		
CC Records Preservation	180,000 00		
Archive	16,000 00		
Justice Court Technology	21,000 00		
Road & Bridge	1,450,000 00		
FM & Lateral Road	600,000 00		
Hot Check Fee	10,000 00		
Sheriff's State Forfeiture	10,000 00		
Child Protective Services	60,000 00		
Health Fund	1,200,000 00		
Airport	40,000 00		
Road Bond 1971	80,000 00		
Permanent Improvement	70,000 00		
Purchase of CD No. 21304402816 on 03/11/2021	12,000,000 00	9/9/2021	0 800%
Retiree Health Benefit Trust	12,000,000 00		
INVESTMENTS AS OF MARCH 31, 2021	78,071,000 00		

THE MARKET VALUE OF ALL INVESTMENTS IS THE SAME AS CARRYING VALUE

To the best of our knowledge and belief, the transactions reflected in this investment report are in compliance with the investment policy of PANOLA COUNTY and conform to the requirements of the PUBLIC FUNDS INVESTMENT ACT

DeAnn Jones
Panola County Judge
Date 3-6-21

Jennita Stacy
Panola County Auditor
Date 3-6-21

W. Reed
Panola County Treasurer
Date 3-6-21

PANOLA COUNTY OFFICIAL/EMPLOYEE
REQUEST FOR ATTENDANCE AT A CONFERENCE

APPROVED

07-06-21

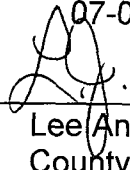

Lee Ann Jones,
County Judge

NAME: Bobbie Davis
POSITION: County Clerk
DEPARTMENT: County Clerk
DATE: June 24, 2021

CONFERENCE: County / District Clerk Region VI Meeting
LOCATION: Jefferson, TX
DATES: July 23, 2021 to July 23, 2021

NUMBER OF DAYS OUT OF OFFICE FOR THIS CONFERENCE: 1

Does the conference meet your educational requirements for the year? yes

If not, how much of your requirements will be met by this conference? _____

How much of your requirements have been met already, not counting this conference?
21.5 hours

How many days have you been away from your job this year for conferences, not counting this conference? 4 days

Do you have sufficient funds in your budget for this conference? yes

Write a short statement explaining the public purpose that will be met by your attendance at this conference: (continue on the back if necessary.)

This regional meeting will cover current items of interest + specific information for Region VI Clerks.

APPROVED

07-06-21

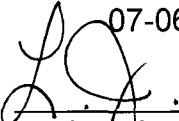

Lee Ann Jones,
County Judge

PANOLA COUNTY OFFICIAL/EMPLOYEE
REQUEST FOR ATTENDANCE
AT A CONFERENCE

NAME: Gina Goldman
POSITION: Court Coordinator
DEPARTMENT: Judicial - County Court at Law
DATE: Oct 12-15, 2021
CONFERENCE: Texas Assoc. for Court Adm. 45th Annual Conf.
LOCATION: Frisco, Texas
DATES: October 12 to October 15, 2021
NUMBER OF DAYS OUT OF OFFICE FOR THIS CONFERENCE: 4
Does the conference meet your educational requirements for the year? yes
If not, how much of your requirements will be met by this conference? 16 hrs.
How much of your requirements have been met already, not counting this conference?

0

How many days have you been away from your job this year for conferences, not counting this conference? none

Do you have sufficient funds in your budget for this conference? yes

Write a short statement explaining the public purpose that will be met by your attendance at this conference: (continue on the back if necessary.)

Rule 6 of the Rules of Judicial Education and
the Texas Gov't Code, Section 74.106 (a) require
a court coordinator of a CCL to obtain 16
hours of CE each year. The fiscal year runs
Sept. 1 - Aug. 31